

Quick Start Guide

About your phone



NOTE: Devices and software are constantly evolving. The screen images and icons you see here are for reference only.

*NOTE: PTT and SOS functionality not available on all models. See User Guide for more details.

Features

- IP68 dust proof and waterproof (6.5 ft deep for up to 30 min), and MIL-STD-810H durability
- Loud 100dB+ dual front speakers to hear and be heard clearly
- 1770mAh battery and USB Type-C charging
- Multi-use charging contacts
- Large, tactile glove-friendly keypad and buttons
- PTT, SOS, External speaker, and Call list keys are also user-programmable to access other functions
- 2-Year Standard Manufacturer's Warranty

NOTE: For safety & warranty information, press **Menu > Settings & tools > Settings > About phone > Safety & Warranty**, or visit the Kyocera website at [KyoceraMobile.com/Support/Phone](https://www.kyoceramobile.com/Support/Phone) and select your phone.

What is in the box?

- Phone
- Removable Li-Ion battery
- AC adapter (Type-A USB connector)
- Type-A to Type-C USB cable
- Quick Start Guide

Contact information

- Find out more about Kyocera [kyoceramobile.com/](https://www.kyoceramobile.com/)
- Phone support and Registration [kyoceramobile.com/support/phone/](https://www.kyoceramobile.com/support/phone/)
- Learn about our white glove service for businesses [kyoceramobile.com/business/business-select/](https://www.kyoceramobile.com/business/business-select/)
- Find accessories [kyoceramobile.com/accessories/](https://www.kyoceramobile.com/accessories/)



DURAXA
EQUIP
by **KYOCERA**

© 2022 Kyocera Corporation. All rights reserved. KYOCERA is a registered trademark of Kyocera Corporation. All other trademarks are the property of their respective owners.

Setting up your phone

Step 1. Remove the battery cover.

Using a coin, rotate the battery cover screw on the back of the phone counter-clockwise several times to loosen it. (You should hear a click when the screw is loose.)

Insert your fingernail into the slit at the bottom of the battery cover and lift the battery cover.



Step 2. Install a SIM/microSD™ card.

NOTE: microSD cards are sold separately.

Lift the SIM/microSD guard tab by its edge until it stands up; then grip and pull the tab to flip open the guard.

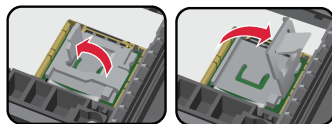

Slide the SIM card into the slot with the gold contacts facing down until it snaps into place.

When a SIM card is already installed, skip the step above. If you need to replace it, push the original SIM card gently and then release the pressure to take it out before inserting the new SIM card.

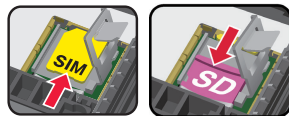

Insert the microSD card carefully into the slot with the gold contacts facing down if necessary.

Place back the SIM/microSD guard.

Step 3. Insert the battery.

Insert the battery, making sure to align the gold contacts. Press down gently to secure the battery.



Step 4. Replace the battery cover.

Replace the battery cover, making sure all the tabs are secure and there are no gaps around the cover.



Using a coin, rotate the battery cover screw clockwise until it is tight.



NOTE: Make sure you press all around the edges of the battery cover to ensure your phone's waterproof seal is intact.

Step 5. Charge your phone.

Before turning on your phone, charge it fully.

NOTE: Only use a USB Type-C charger/cable for this phone.

Open the USB/Charger port cover.

Insert the small end of the USB cable into the USB/Charger port. Insert the larger end into the AC adapter and plug it into an outlet.

When charging is complete, remove the cable from the port and securely close the cover.

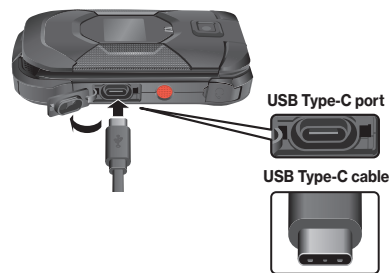

WARNING: Use only approved chargers and cables with your phone. Improper handling of the charging port, as well as the use of an incompatible charger or cable, may cause damage to your device and void the warranty.

NOTE: Make sure the USB/Charger port cover is securely closed, when the port is not in use, to maintain your phone's waterproof seal.

Using your phone

Turning your phone on/off

To turn your phone on, open the phone and press and hold the **END/POWER** key until the screen lights up.

To turn your phone off, press and hold the **END/POWER** key until you see the powering-down animation on the main screen.

Make a call

1. Open the phone and enter a phone number.
2. Press the Center soft key [**Call**] or **SEND** key.
3. To end the call, press the **END/POWER** key.

Take a picture/Record a video

1. Open the phone and press the **Camera/ Speaker** key.
2. Press the Center soft key [**Take**] to take a picture.

– or –

Press the Left soft key [**Record**] to begin recording. Press the Center soft key [**Stop**] to stop recording.

Selecting menu items

1. Press the Center soft key [**Menu**].
2. Scroll through on-screen items by using the navigation key up, down, left, or right. As you navigate through the menu, menu options are highlighted.
3. Select any option by highlighting it and pressing the Center soft key [**Select**].
4. Repeat step 3 until the menu item you want to use is displayed.

Connecting the Wi-Fi

1. Press the Center soft key [**Menu**].
2. Select **Settings & tools > Settings > Wireless & networks > Wi-Fi**.
3. Select **Wi-Fi**.
4. Highlight **On**, then press the Center soft key [**Set**].
5. Highlight a Wi-Fi network you want to connect to and press the Center soft key [**Select**].
6. Enter the password and press the Center soft key [**Save**].